

Press screw connection with male thread

Material

- Main body: pressed brass type CW617, nickel-plated from the outside, on surfaces, which do not have contact with water –
- full anti-diffusion barrier
- Clamping ring: stainless steel
- O-ring gasket: EPDM

Area of application

- Installations of hot & cold tap water
- Central heating (radiator connections)
- Surface heating (underfloor and wall heating installations)
- Ice water

Overview

The connection between the pipe and the fitting is obtained by pressing the pipe into the fitting's profile. The pressing should be made in the connection area, with a pressing tool equipped with U-type inserts, matched to the type of fitting used. The tightness of the connection chamber is guaranteed by two O-rings, perfectly integrated into the joint area. Pressed connections can be used in the floor groove or a wall furrow.

Dimensions

Size	L1	L2	D	L	Rp	Rp1	Rp2	I1	I2	I	Code
40x1 1/2"	45	23,5	31,8	21	45x2	1 1/2"	45x2	20	14	45	06011511
50x1 3/4"	45	23,5	40,8	21	54x2	1 1/2"	54x2	20	14	45	06011513

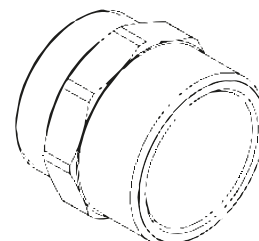
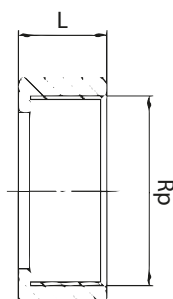
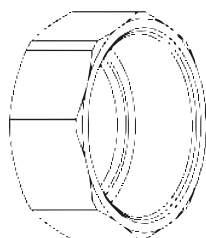
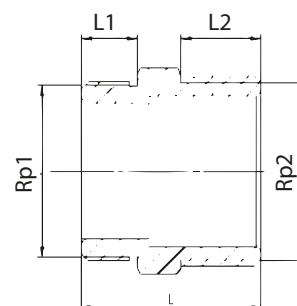
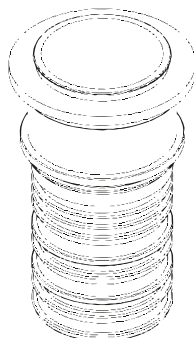
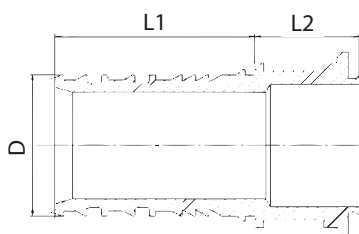

Tweetop sp. z o.o.
Ludowa 24c | 71-700 Szczecin

Scope of delivery

Main body with sealing and clamping rings