

## Press screw connection with female thread

### Material

- Main body: pressed brass type CW617, nickel-plated from the outside, on surfaces, which do not have contact with water –  
- full anti-diffusion barrier
- Clamping ring: stainless steel
- O-ring gasket: EPDM

### Area of application

- Installations of hot & cold tap water
- Central heating (radiator connections)
- Surface heating (underfloor and wall heating installations)
- Ice water

### Dimensions

Size	L1	L2	D	L	Rp	Code
16x1/2"	26	16	11,8	15,5	1/2"	06011403
20x3/4"	26	17	15,8	15,5	3/4"	06011405
20x1"	26	17	15,8	17,5	1"	06011407
25x3/4"	32,6	16,4	19,8	15,5	3/4"	06011409
25x1"	32,6	17,4	19,8	17,5	1"	06011411
32x1"	32,6	16,9	25,8	17,5	1"	06011413

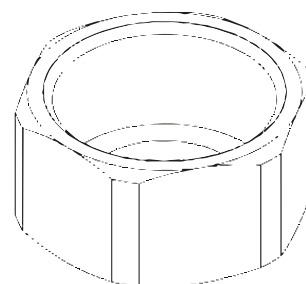
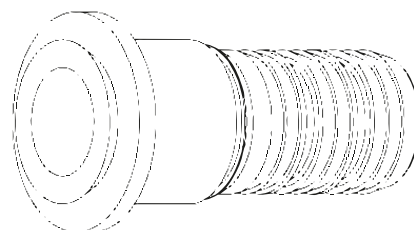
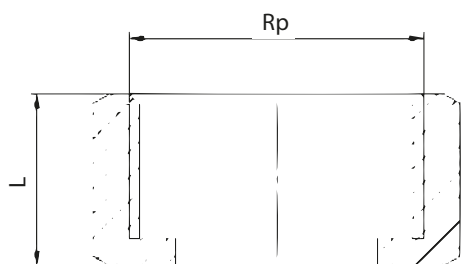
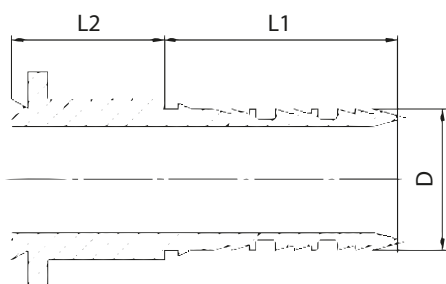

### Overview

The connection between the pipe and the fitting is obtained by pressing the pipe into the fitting's profile. The pressing should be made in the connection area, with a pressing tool equipped with U-type inserts, matched to the type of fitting used. The tightness of the connection chamber is guaranteed by two O-rings, perfectly integrated into the joint area. Pressed connections can be used in the floor groove or a wall furrow.

### Scope of delivery

Main body with sealing and clamping rings